

RECOMMENDED
PANEL CUTOUT

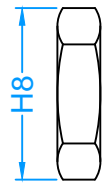

H8

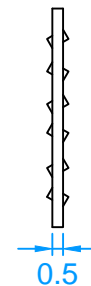

0.5

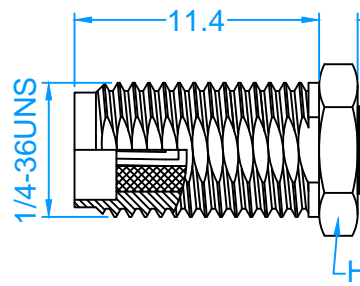

11.4

1/4-36UNS

H8

Length

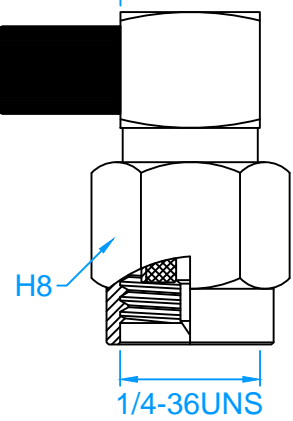

H8

1/4-36UNS

Part Number	Length (IN)	Length (MM)
KM-020812-0100	3.937±0.15	100±4
KM-020812-006I	6±3%	152.4±3%
KM-020812-001F	12±3%	304.8±3%

- Orient SMA plug interface in relation to SMA jack 'D flat' within ± 45° as shown, but only for cable lengths less than 150mm.
- Additional lengths can be provided by replacing XXXX to the desired length in MM, or XXXI in INCH, or XXXF in FEET.
- Any queries feel free to consult our sales team at sales@dgkemy.com

4	Heat Shrink Tubing	2	Black
3	SMA (M) Plug	1	KM-010135
2	SMA (F) Jack, BHD	1	KM-010105
1	Coaxial Cable	1	RG178
No.	Specification	QTY	Description

**RoHS
Compliant**

THIRD ANGLE PROJECTION

* MAJOR DIMENSION UNLESS OTHERWISE NOTED TOLERANCES	SCALE	1:1	UNIT	MM
---	-------	-----	------	----

APPROVED TERRY
CHECKED JOHN
DRAWN KEVIN
DRAWN DATE 09 Apr. 2008

KM KeMy Electronic Technology Inc.	
TITLE SMA (F) Jack, BHD - RG178 - SMA (M) Plug, R/A, Various Lengths	
DRAWING NO.	REV
KM-020812-XXXX	A